

# SHRINK PACKING MACHINE

Standard model: BSD3520A

BSD4020A

BSD4525A



OPERATION INSTRUCTION

## CONTENTS

1. Profile .....	1
2 .technical parameters .....	1
3. Specification.....	2
4. Operation panel.....	2
5. Installation and operation.....	2-4
6. Troubleshooting.....	4
7. Warranty card.....	5
8. Schematic.....	6
9. Part list.....	7-8

## **1 .Profile**

Thank you very much for purchasing our shrink packing machine.

This packing machine is widely used for packing such products as foodstuff, electronic products, toys, metal ware , cosmetics ,medicine ,daily consumables, books and elastic appliances and this packing results in fine appearance, dustproof, moistureproof and fresh-keeping effect, reduces product waste and cost. To achieve optimal operation and packing effect, please read this manual carefully prior to use.

## **2. Technical parameters**

● This packing is a new-style equipment of automatic continuous Shrink. Combination with international leading contraction air-blowing technology and constant improvement results in unique design, manufacture, consistent hot air and optimal contraction effect.

● Use quartzose heater with high-efficiency of economy electric, The shrinking temperature can be control and big adjust scope which ensures stable operation.

● The imported convey speed can be adjust and with device of centenarian –bar running automatic, and long nonstop operation.

● The conveyor drum made of silicon rubber tube features thermostability wear resistance, non-deformation and durable usability and does not burn films.

### 3. Specification

Model	BSD3520A	BSD4020A	BSD4525A
Power supply	110V/220V/380V/50-60Hz		
Heater power (KW)	8	10	12
Conveyor speed (m/min)	0-15		
Tunnel size (mm)	800×350×200	1000×400×200	1000×450×250
Product size (mm)	300×160	350×160	400×210
Conveyor loading (kg)	15(max)	25(max)	25(max)
Tunnel temperature (°C)	200(max)	200(max)	200(max)
Machine size (mm)	1050×610×1320	1250×660×1320	1250×710×1370
Machine weight (kg)	80	100	120
Shrink film	PVC.PP.POF		

NOTE: BROTHER factory reserves the right to change the above machines specification at any time for better performance.

### 4. Operation panel

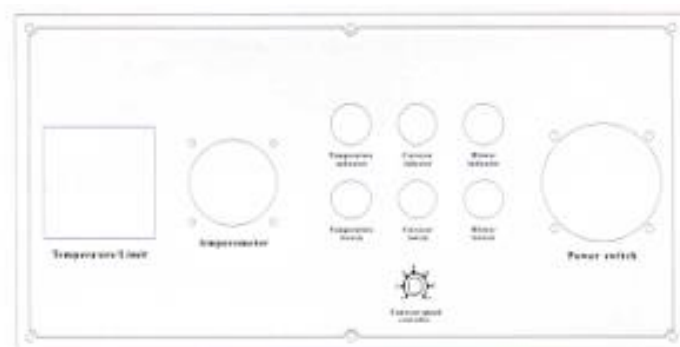

### 5. Installation and operation

5.1 Install two base wheels on the racks with fixing screws. And place the machine on solid, flat and vibration-free ground.

Warning: this unit must be well grounded.

5.2 After completing electric connection, switch on power and the power indicator will light up, now check the direction of the blower motor, it should run counter clock wise. If not, please change the phase connection, or it will affect contraction effect.

5.3 Set up contraction temperature as required by contraction material. It is not necessary to turn on the blower motor immediately after power is switched on. Turn on the blower motor when temperature has come up to the preset value.

**Special attention: the blower must be on when the machine is on operation or it will affect the operation of the machine and the effect of packing.**

Film \ Tem	PVC	PP	POF	C3	D955	PE
130°C	●					●
150°C		●	●	●	●	
180°C						

**Notes: temperature will rise when the convey belt speeds up and drop when it slows down to meet the requirement of productions.**

5.4 Turn on the speed controller to adjust the conveyor speed to the optimal contraction effect according to the contraction film and temperature settings.

5.5 Before switching off power. Please set the temperature at “°C”and the conveyor at normal speed and have it run for 10-15minutes to have the machine cool dawn naturally this can prolong its service life.

Warring : avoid loading moist .liquid-containing thick, inflame-mable.

**Pressurized and aerated, volatile and fine materials and materials.**

**That may affect normal operation or do harm to the machine.**

## 6. Troubleshooting

Symptom	Cause	Solution
Undesirable contraction film	Wrong direction of blower motor	Change phase line
	Conveyor belt too fast	Adjust temperature
	Temperature too high	Adjust speed
Damage to contraction film	Temperature to high	Adjust temperature and speed
Loud noise	Lack of lubricant	Add lubricant
Low temperature after heating	Damaged heating tube	Replace heating tube
Sudden breakdown	Loose or disconnected electric connector	Check power supply
	Fuse blown out	Replace fuse cartridge

## **7. Warranty card**

The warranty card shall be valid for 365 days commencing on the date of purchase and include the following:

7.1 Please provide your warranty card and certificate of purchase for maintenance of the product within the valid warranty period.

- a) The warranty card shall not be reissued in case of loss.
- b) The warranty card is only applicable to China.

7.2 Our company will offer free maintenance commencing on the date of purchase in case of fault arising from normal operation.

- a) Main control system
- b) Main motor

7.3 Free maintenance shall not include the following circumstances even during the valid period of warranty:

- a) No warranty card or certificate of purchase available
- b) Fault arising from improper operation or unstable power supply
- c) Fault arising from disaster (earthquake, fire flood, drops down or damage)
- d) Dismantling without our authorization

## 8. Schematic diagram

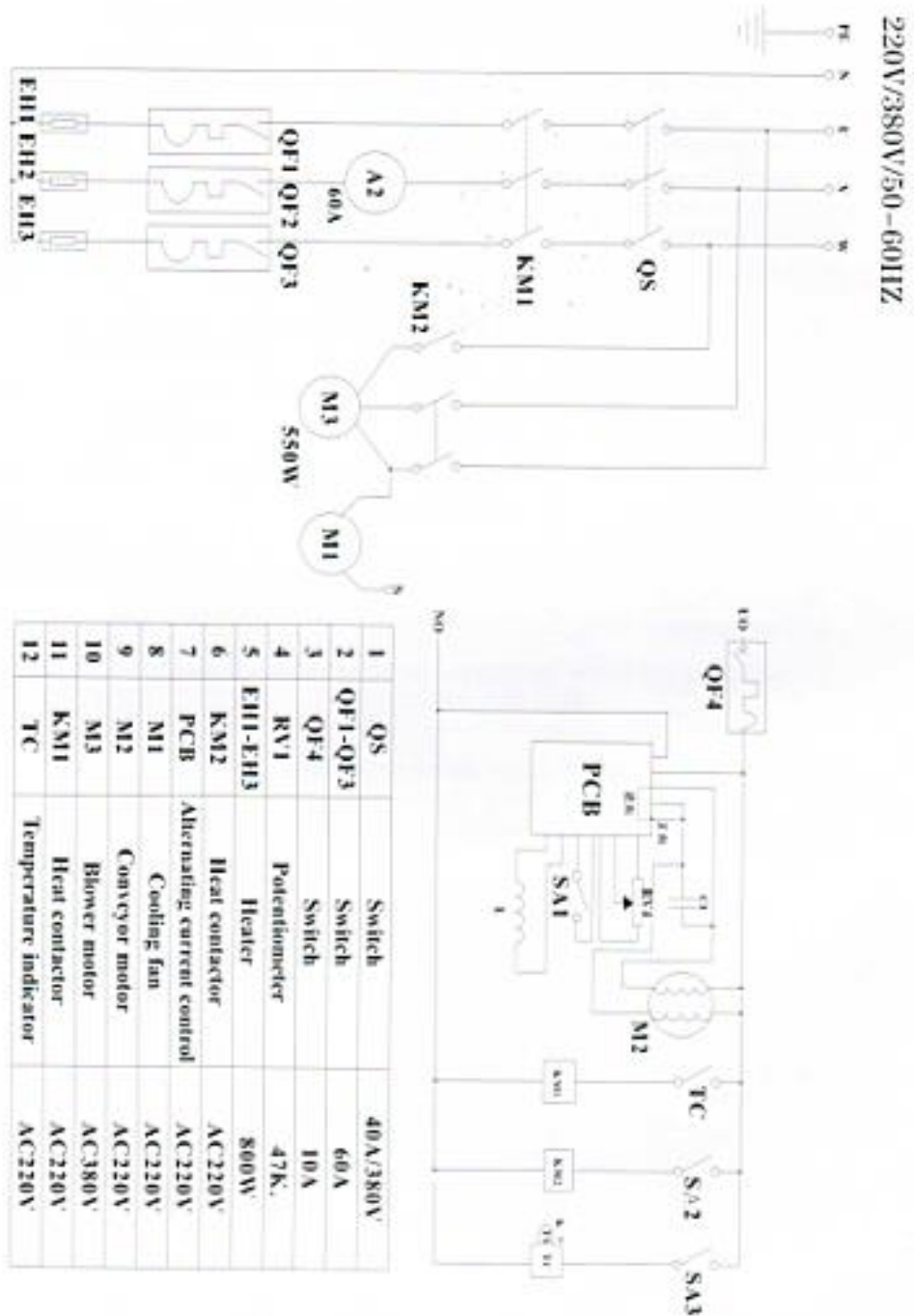



## 9. Part list

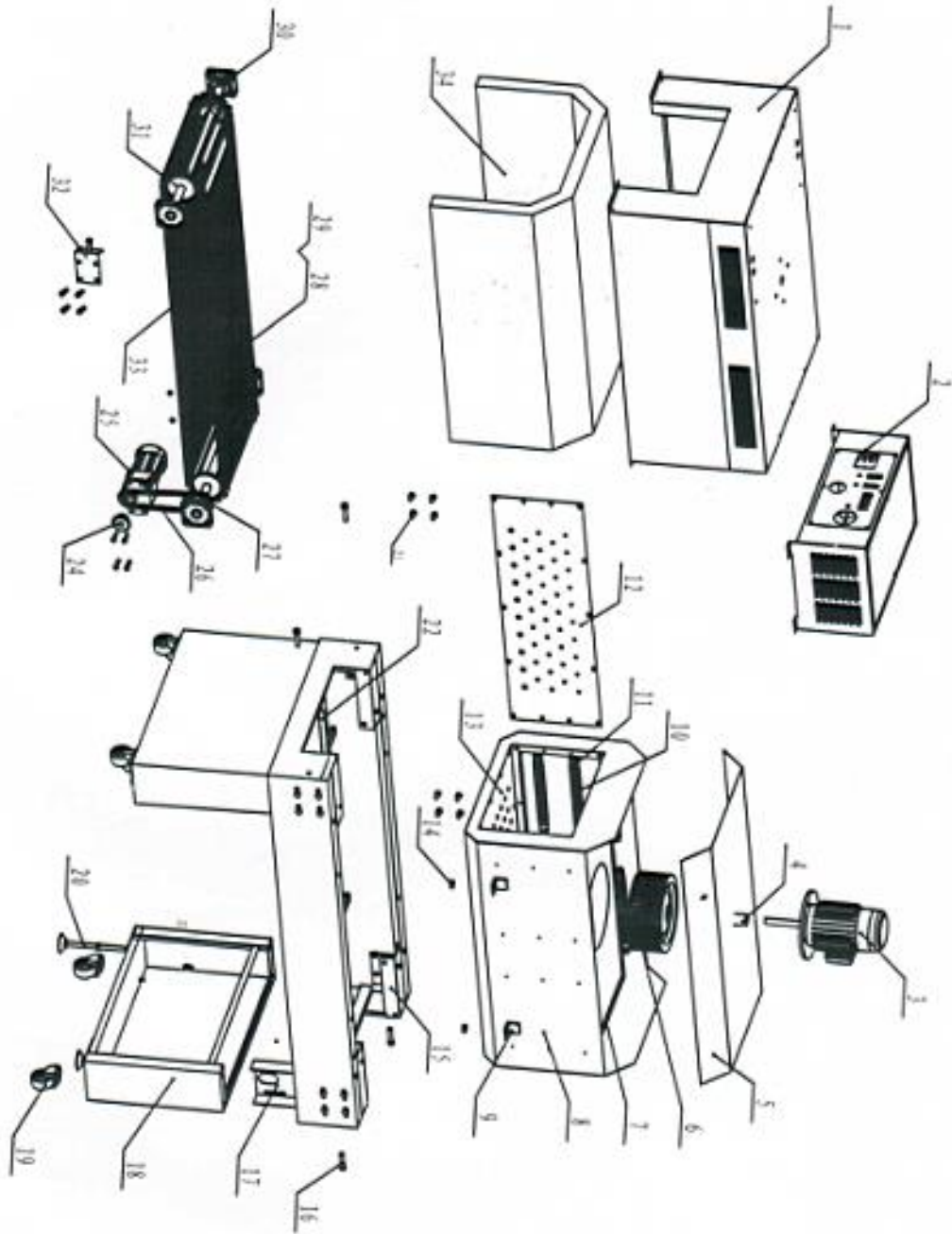

## 9. Part list

Item no.	Part description	Q'ty	Reference	Item no.	Part description	Q'ty	Reference
1	crust	1		18	horse	2	
2	electric box	1		19	caster	4	
3	running motor	1		20	adjust bolt	4	
4	motor axis washer	1		21	Fixed bolt	8	
5	baker up-cover	1		22	plastic jacket	2	
6	running fan	1		23	Bearing seat fixed bolt	16	
7	baker build in frame	1		24	motor chain wheel	1	
8	inner baker	1		25	convey motor	1	
9	baker connect board	4		26	driving chain bar	1	P=9.525
10	quartzose heater	12		27	driving chain wheel	1	
11	fixation knot	24		28	chain bar axis	102	
12	baker outer-cover	2		29	silia gel knot	102	
13	baker inner-cover	1		30	Bearing seat	4	
14	baker underlay	4		31	driven chain wheel	4	
15	machine frame	1		32	driven chain adjust board	4	
16	driven chain adjust bolt	4		33	convey chain bar	2	P=12.7
17	motor frame	1		34	Heat preservation asbestus	1	